

# MONTGOMERY COUNTY PUBLIC SCHOOLS

## AUBURN STRAND SCHOOLS BLACKSBURG HIGH SCHOOL

School Board GMP Presentation  
February 28, 2012



SHW GROUP



## Where are we in the PPEA process?

- School Board Update – September 27
- Site Work is on-going at both projects
- 65% Design Submission – December 22
- Foundations have started at both projects
- Branch is currently obtaining pricing to develop the GMP
- School Board Update – January 26
- GMP Presentation to the Building Committees –February 27
- **Present the GMP to the School Board – February 28**



SHW GROUP





## ***Auburn High School***





## ***Blacksburg High School***



SHWGROUP



# WHAT IS THE CCL?



SHW GROUP



THE CCL IS THE ***CONTRACT  
COST LIMIT*** THAT WAS  
ESTABLISHED IN THE  
COMPREHENSIVE AGREEMENT.



# WHAT IS THE GMP?



SHW GROUP



THE GMP IS THE ***GUARANTEED  
MAXIMUM PRICE*** FOR THE  
PROJECT TO BE ESTABLISHED  
AT 65% DOCUMENT  
DEVELOPMENT





CCL = 109,995,000

+ 990,000 SF ADJUSTMENTS FOR BHS & AMS

+ 500,000 DEMO OF EXISTING AMS TO PE

---

\$111,485,000 = Proposed Adjusted CCL

\$124,500,000 = Total Project cost including  
Both MCPS and PE



The GMP is the CCL



SHW GROUP



# WHY?

- Challenging Schedules
- Secured pricing at 65% design milestone
- Project size, schedule, and complexity eliminates a portion of the subcontractor market in certain trades
- Fluctuating fuel prices
- Prices are volatile for any product manufactured with petroleum
- A number of projects starting in the area at the same time
- Bidding climate is starting to change
- The delayed start of the work at AMS



SHW GROUP



# THE GOOD NEWS...

- Pursue cost saving solutions with the subcontractors
- PE has contributed a portion of the contingency to partner in the process
- We have been able to include 13 Science Labs at BHS along with a robust CTE program space
- Maintained priorities set by the Building Committees at each school
- No square footage reductions
- Energy efficient designs that will be a benefit to the county for a long time to come.



What is different?



SHW GROUP







# Montgomery County Public Schools



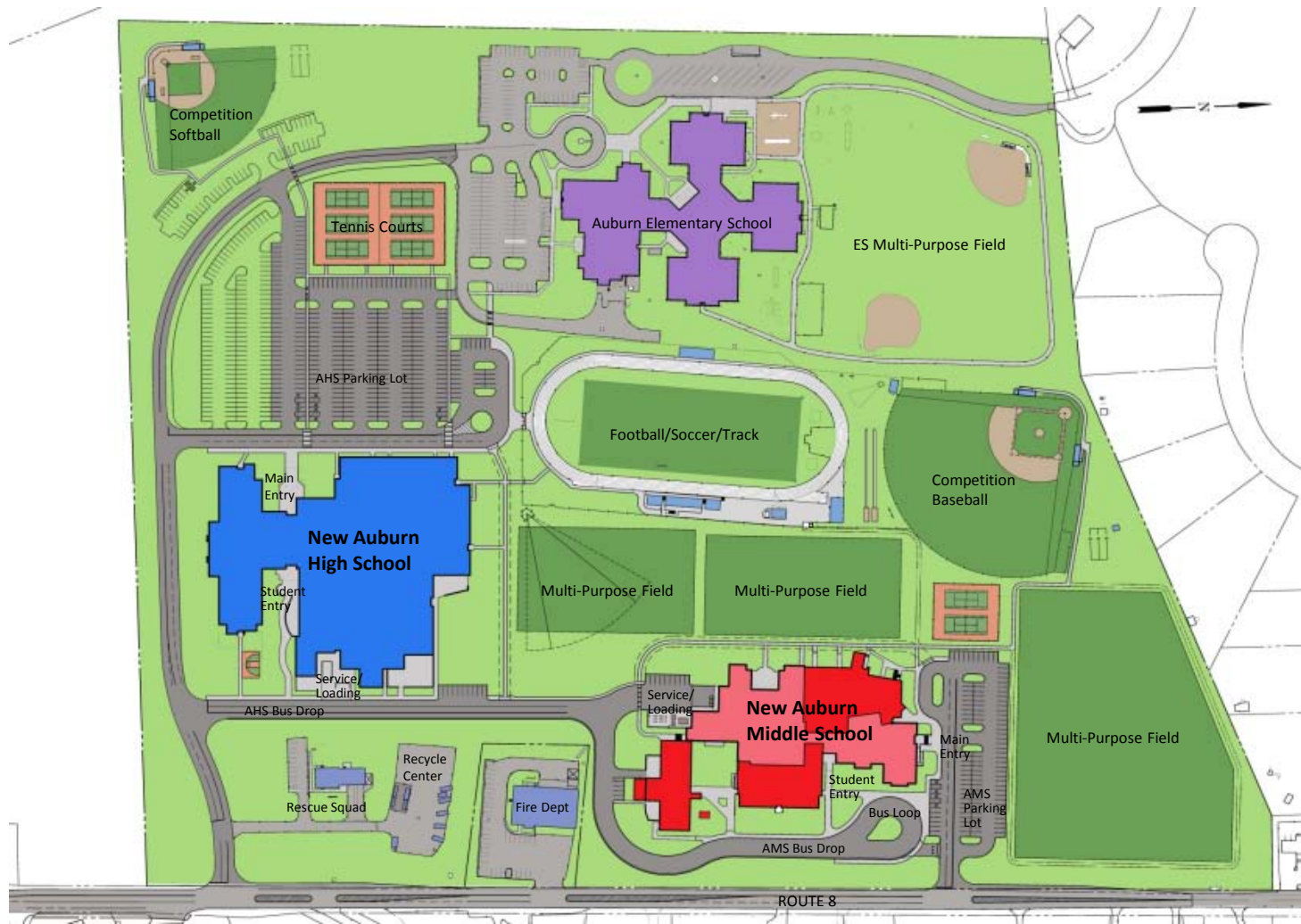

## **Auburn Strand – Site Plan**

Montgomery County Public Schools





**New Auburn High School – Main Entry Perspective**  
Montgomery County Public Schools

Where are we with the  
Middle School?



Montgomery County  
Public Schools





# MONTGOMERY COUNTY PUBLIC SCHOOLS

## BLACKSBURG HIGH SCHOOL

School Board Update  
February 28, 2012

---



Montgomery County  
Public Schools

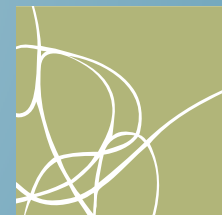

SHWGROUP









## Learning Commons - before



Second Floor Looking North



Third Floor Looking South



First Floor at Amphitheater Stair



Second Floor Looking South

65% CD VIEWS

BLACKSBURG HIGH SCHOOL | SHW Group  
BUILDING COMMITTEE DESIGN REVISION REVIEW  
FEBRUARY 27, 2012



## Learning Commons - after



Second Floor Looking North



Third Floor Looking South

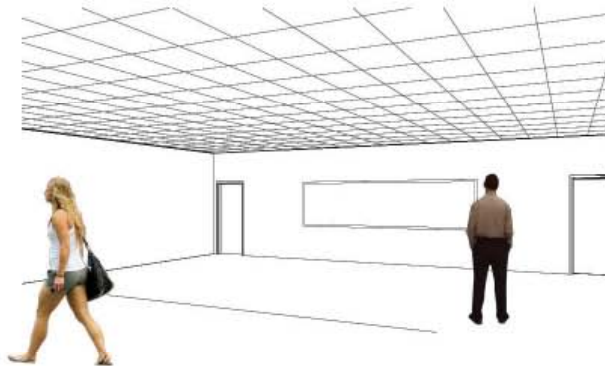

First Floor CTE Learning Commons



Second Floor Looking South

CURRENT VIEWS

BLACKSBURG HIGH SCHOOL | SHW Group  
BUILDING COMMITTEE DESIGN REVISION REVIEW  
FEBRUARY 27, 2012



In the interest of student safety, portions of this slideshow which included specific building plans were removed from the online version in accordance with Section 2.2-3705.02 of the Code of Virginia. These documents may be viewed in person by attendance at a building committee meeting or by scheduling an appointment with the board clerk at 382-5138.